



Home Models Accessories Gallery Feedback Contact Us

search

Adria Models

Geist Models

Hymer Models

T@B Models

Used Caravans



Adria



Adria caravans are built in Slovenia (next to Italy - top of the boot and turn right) and sold across Europe, England, Japan and Australia. Adria have been building caravans for over 40 years. They come to us highly recommended, by industry professionals and by owners.

European caravans are rapidly gaining popularity across the world for their innovation in interior design and technological advances resulting in caravans that are lighter and stronger with better towing manners built in. Plus, most importantly, the European vans are beautifully finished and are aesthetically pleasing and functional places to spend your leisure time.

In short, reasons to consider an Adria Caravan are:

- Strength
- Light Weights
- Fully Insulated
- Tough Polyester Exterior w. Plastic Front and Rear Walls
- Beautiful Interiors
- Lots of Storage Areas
- Superb Towing Manners
- Excellent Value For Money



It's in the details



ADRIA Models

ADRIA 532 LT



- 4 Berth
- 1281kg Tare / 1500kg ATM
- Polyester Walls and Roof
- Alloy Wheels
- Shock Absorbers
- ALKO Chassis
- AKS Stabiliser Hitch
- Corner Steadies
- Step
- Battery



- 180° Views from Front Lounge
- Heki II Sky Light
- Fly Mesh and Blinds on all Windows
- 2 Singles or Double Bed
- Overhead Lockers



- Dinette
- Converts to 2 Bunk Beds
- Divider Curtain



- Galley Kitchen
- Spinflo 4 Hob Burner w. Mini Grill
- Stainless Sink
- Mixer Taps
- Dometic 971 Fridge
- 50l Water Tank
- Truma Hot Water System



- Separate Shower
- Thetford Cassette Toilet
- Vanity w. Mirror
- Cupboards

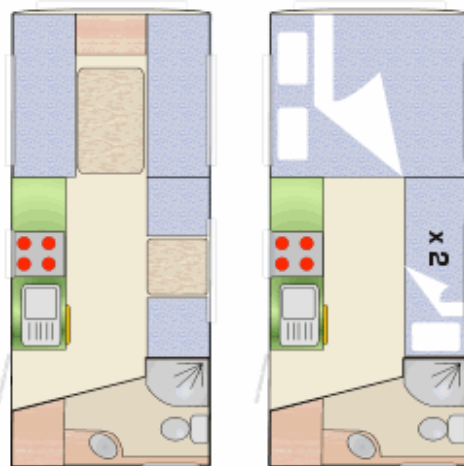

- 5 Year Water Ingress Warranty
- **\$45,990** tow away

Dominic says "Pretty well all the quality of other European brands but at a lower price. Adria offer a lot of van for the price."

Benedict says "This van majors in space, lots of floor space and a huge 'openess' around your head. Very nice."

Ian says "Having the side dinette turning into bunks is a great way of turning your tourer into a family van."

ADRIA 532 UP



- 4 Berth
- 1352kg Tare / 1500kg ATM
- Polyester Walls and Roof
- Alloy Wheels
- Shock Absorbers
- ALKO Chassis
- AKS Stabiliser Hitch
- Corner Steadies
- Awning
- Entry Step
- Battery



- Forward Lounge with 180 degree views
- Converts to Large Double Bed
- Free Standing Table
- Heki II Skylight
- Fly Mesh, Blinds and Curtains for all windows
- Overhead Lockers
- Clarion Radio CD Player with Speakers



- Galley Kitchen
- Workspace Extender
- 97 l Dometic Fridge
- Spinflo 4 hob Burner with grill and oven
- Spinflo Stainless Steel Sink
- Mixer Tap
- Plenty of storage



- Airconditioning
- Hanging Cupboard
- Microwave
- Truma Gas & Electric Hot Water



- Cozy Bedroom
- Inner Spring Mattress
- Anti Microbial Protection for mattress
- Servery / TV hatch to kitchen
- Under bed storage with external hatch



- Spacious Bathroom and Shower
- Thetford Cassette Toilet
- Extra Shelving /Storage throughout



- Vanity Sink with mirror and storage
- Mixer Tap

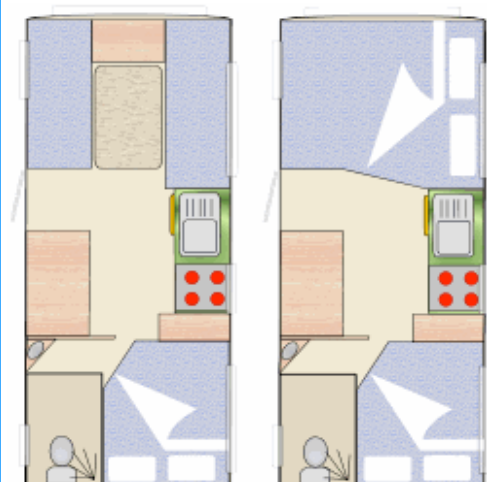

Read the Review



with thanks to
Australian Caravan + RV Magazine

- 5 year water ingress warranty
- **\$52,990** tow away

Dominic says "This is probably the van that will make Adria's name in Australia - so many features and only 1,352kg."

Benedict says "You fall in love with this van as soon as you walk in. Every time!"

Ian says "While this is a relatively small van it has such a great functionality and feel that it is a real winner. My wife wants one."

ADRIA 642 UP



- 4 Berth
- 1572kg Tare / 2000kg ATM
- Polyester Walls and Roof
- Twin Axle
- Alloy Wheels
- Shock Absorbers
- ALKO Chassis
- AKS Stabiliser Hitch
- Corner Steadies
- Awning
- Entry Step



- Forward Lounge with 180 degree views
- Converts to Double Bed
- Free Standing Table
- Heki II Skylight
- Overhead Lockers



- Fly Mesh, Blinds and Curtains for all windows
- Clarion DVD/Radio/CD Player with Speakers
- Side cabinet for extra storage



- Galley Kitchen
- Workspace Extender
- Spinflo 4 hob Burner with grill and oven
- Spinflo Stainless Steel Sink
- Mixer Tap
- Plenty of storage



- 150 l Dometic Fridge/Freezer
- Airconditioning



- Bathroom and Shower
- Thetford Cassette Toilet (electric)
- Extra Shelving /Storage throughout



- Hanging Cupboard
- Microwave
- Truma Gas & Electric Hot Water
- Battery



- End Bedroom
- Inner Spring Mattress
- Anti Microbial Protection for mattress
- Under bed storage with external hatch

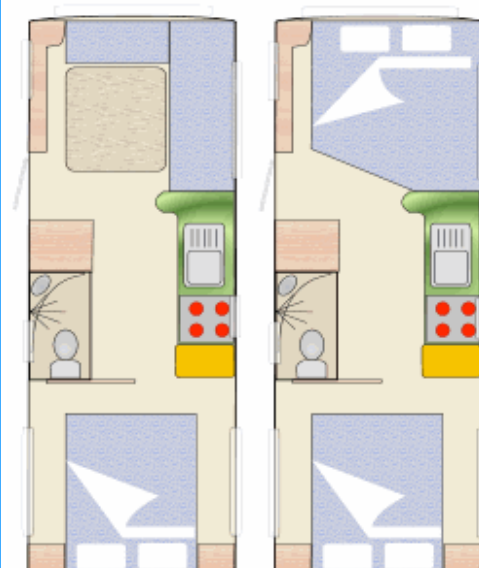

- 5 year water ingress warranty
- **\$62,990** tow away

Dominic says "Again Adria offer great value for money with their own touches to this layout."

Benedict says "The extra space in the kitchen and the front end are good things."

Ian says "Adria are very good with cupboards and storage spaces."

Technologies

Chassis

Like most European vans Adria use a Punched C-Section chassis with rolled edges. The "C" shape saves weight over the older Box Section. Punching further reduces weight. Rolling the edges keeps strength. This method of frame/chassis construction has been common in aeroplanes for decades. The chassis works in conjunction with the floor and walls to create the overall caravan strength. Adria sources their Chassis from chassis giants ALKO.

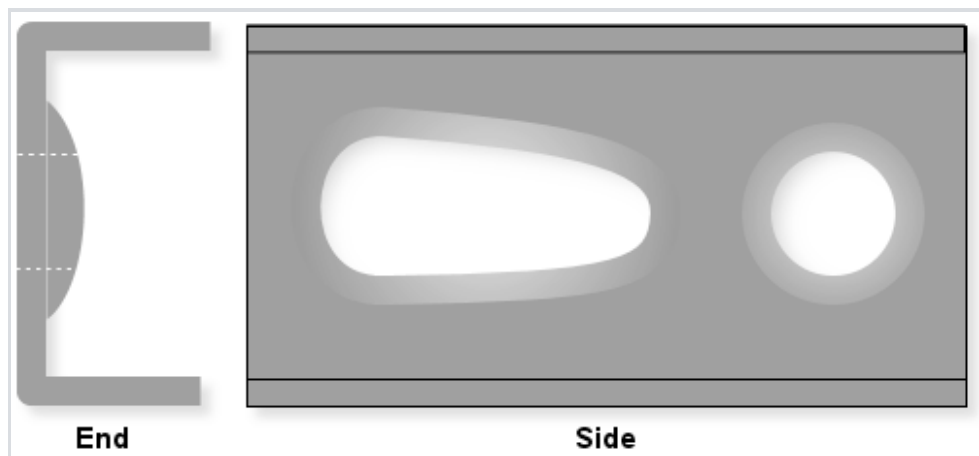

The chassis construction thickness for Australia is increased by about 1.5mm which in structural terms results in an increase of 3-4 times the strength of the same van in England or Europe. Adria recognise that Australian roads are not always perfect ;-) [\) European vans are travelling over unsealed Aussie roads very well.](#)

Stabiliser Hitch

Adria Caravans feature the ALKO Stabiliser Hitch with Breakaway System. The Stabiliser Hitch is a real revolution in towing because it completely removes the need for load levellers, anti-sway bars etc. (saves you money and time too). The Hitch locks onto your towball and then a set of brake sensors "feel" the ball and adjust the van immediately to completely stop that dreaded "swaying".



The Breakaway System is still a little uncommon in Australia but it is very smart. If your caravan comes un-hitched from your tow vehicle (unlikely with this hitch) then the cable will apply the handbrake and snap allowing your car to remove itself from an errant van. The van will fall onto the jockey wheel and coast to a stop on the side of the road. Chains are unnecessary with this system.

If you wish to understand these methods better then please don't hesitate to come in and see them for yourself.

We are based in Brisbane
but that doesn't mean that we only do business in Brisbane.
[Try us](#)

Why not call or email to let us help you own your very own ADRIA



07 3255 8988



dominic@brisbaneproton.com.au